

NOTE: DRAINAGE MAT AND INSULATION ARE NOT SHOWN

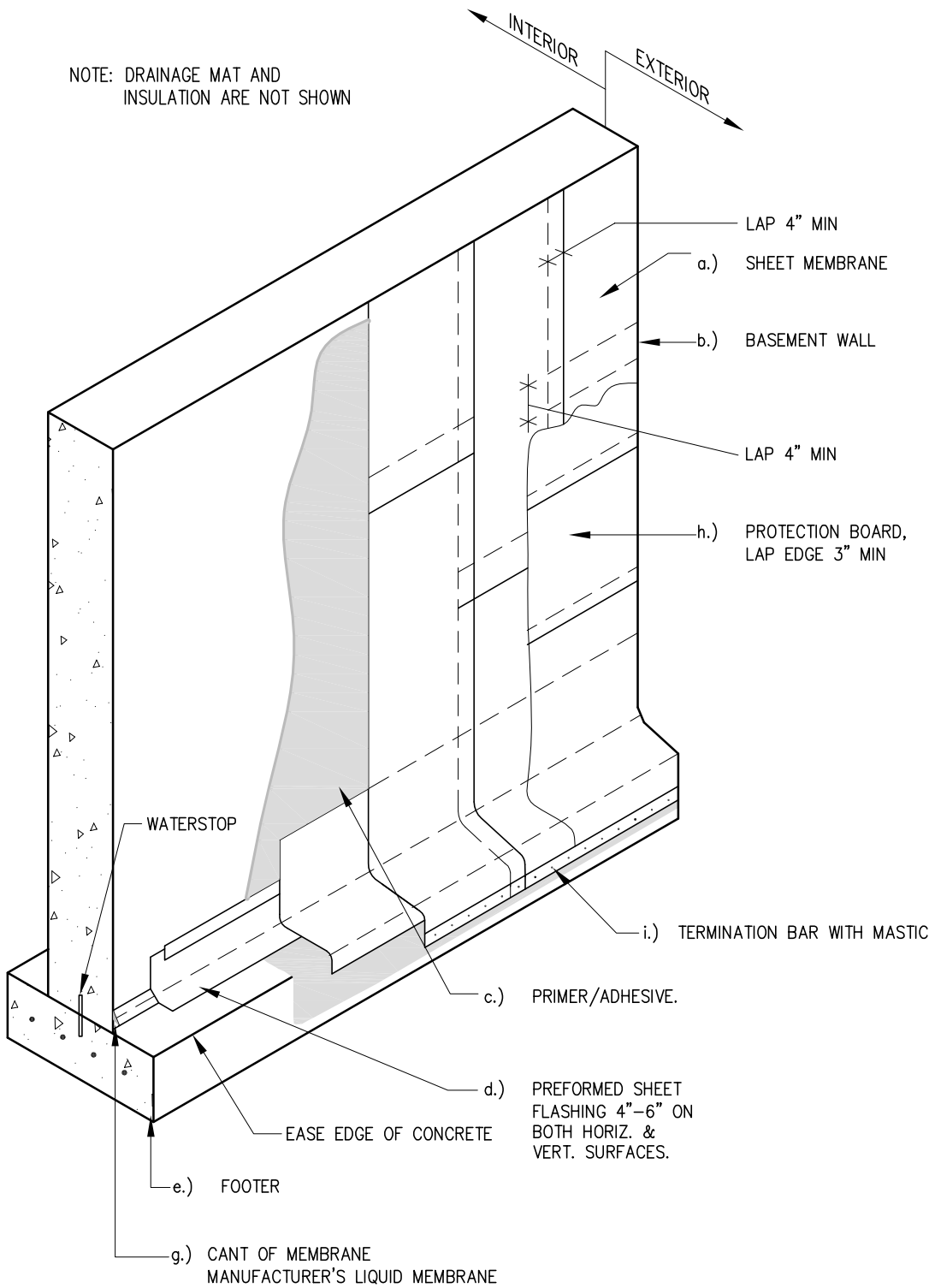

Notes: Component Functions

- a.) Prevents water leaking through wall & into occupied spaces. Protection board prevents damage to membrane.
- b.) Transfers building loads to footer - resists earth loading.
- c.) Primer/adhesive coat for sheet membrane bond to wall.
- d.) Primary seal against water penetration @ wall/footering cold joint.
- e.) Transfers wall loads to subgrade.
- f.) Directs excess water away from wall/footering cold joint.
- g.) Reduces stress concentration of flashing membrane.
- h.) Protection against membrane damage during back fill set in adhesive
- i.) Mechanical fastener to secure bottom of membrane

PRIMER AND PROTECTION BOARD NOT SHOWN

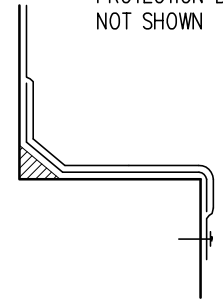

1.2.4

FOUNDATION WALL - SHEET MEMBRANE SYSTEM

CONCEPTUAL - NOT FOR CONSTRUCTION