

Notes: Component Functions

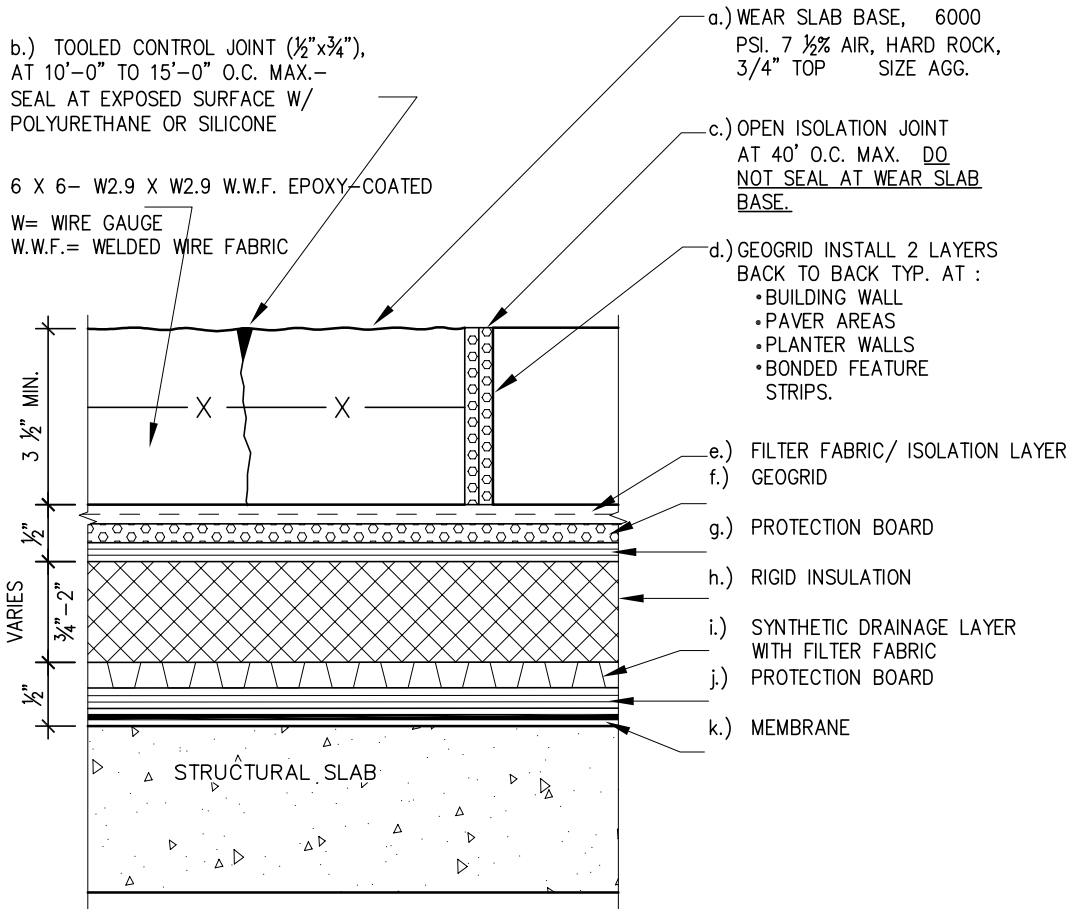

- a.) Serves as a base for final architectural features and/or final load bearing slab.
- b.) Provides crack control in wear slab base.
- c.) Provides vertical isolation in wear slab; limits potential for slab lockage/linkage & long term growth induced thrust.
- d.) Provides expansion/contraction space for movement during seasonal thermal cycles & secondary flow path.
- e.) Reduces friction; "low shear" plane to accept slab movement above geogrid.
- f.) Primary flow path for invasive surface water.
- g.) Serves as a base for geogrid.
- h.) Provides a thermal envelope.
- i.) Secondary drain/isolation layer, removes water to plaza drain basin.
- j.) Protects membrane from subsequent const. operations.
- k.) Prevents water entry into occupied spaces.

1.4.2

PLAZA DECK SYSTEM - WEAR SLAB BASE

CONCEPTUAL - NOT FOR CONSTRUCTION