

Notes: Component Functions

- a.) Protection against membrane damage during backfill - set in "tacky" membrane.
- b.) Primer/adhesive coat for liquid membrane.
- c.) Liquid membrane rolled or sprayed.
- d.) Primary seal against water penetration @ wall/ footing cold joint.
- e.) Reduces stress concentration on flashing membrane.

NOTE: DRAINAGE MAT AND INSULATION ARE NOT SHOWN

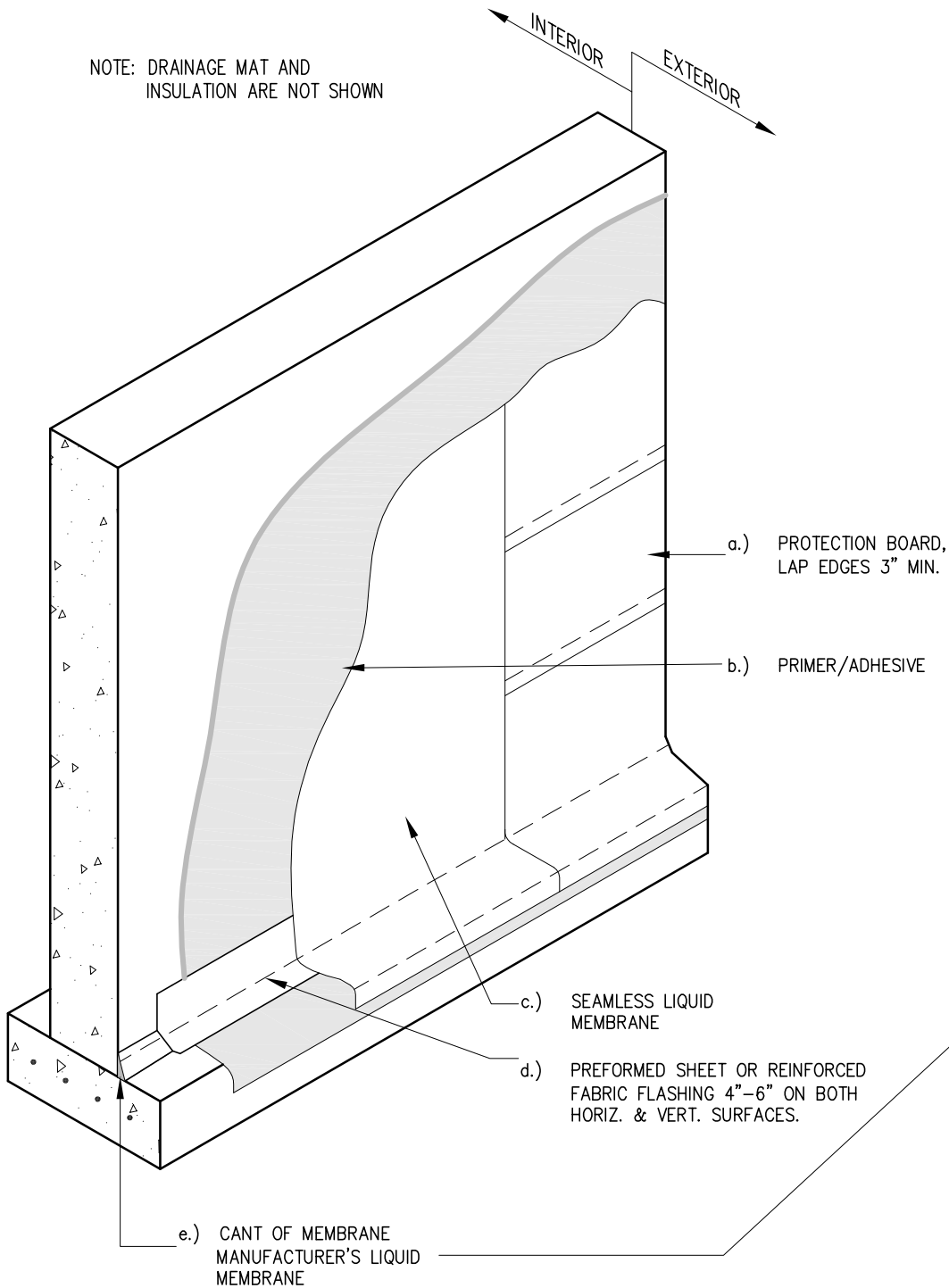

PRIMER AND PROTECTION BOARD NOT SHOWN

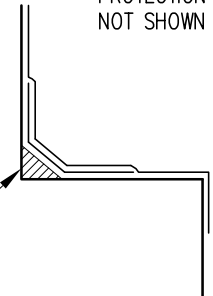

1.2.3

FOUNDATION WALL - FLUID-APPLIED MEMBRANE SYSTEM

CONCEPTUAL - NOT FOR CONSTRUCTION