

Notes: Component Functions

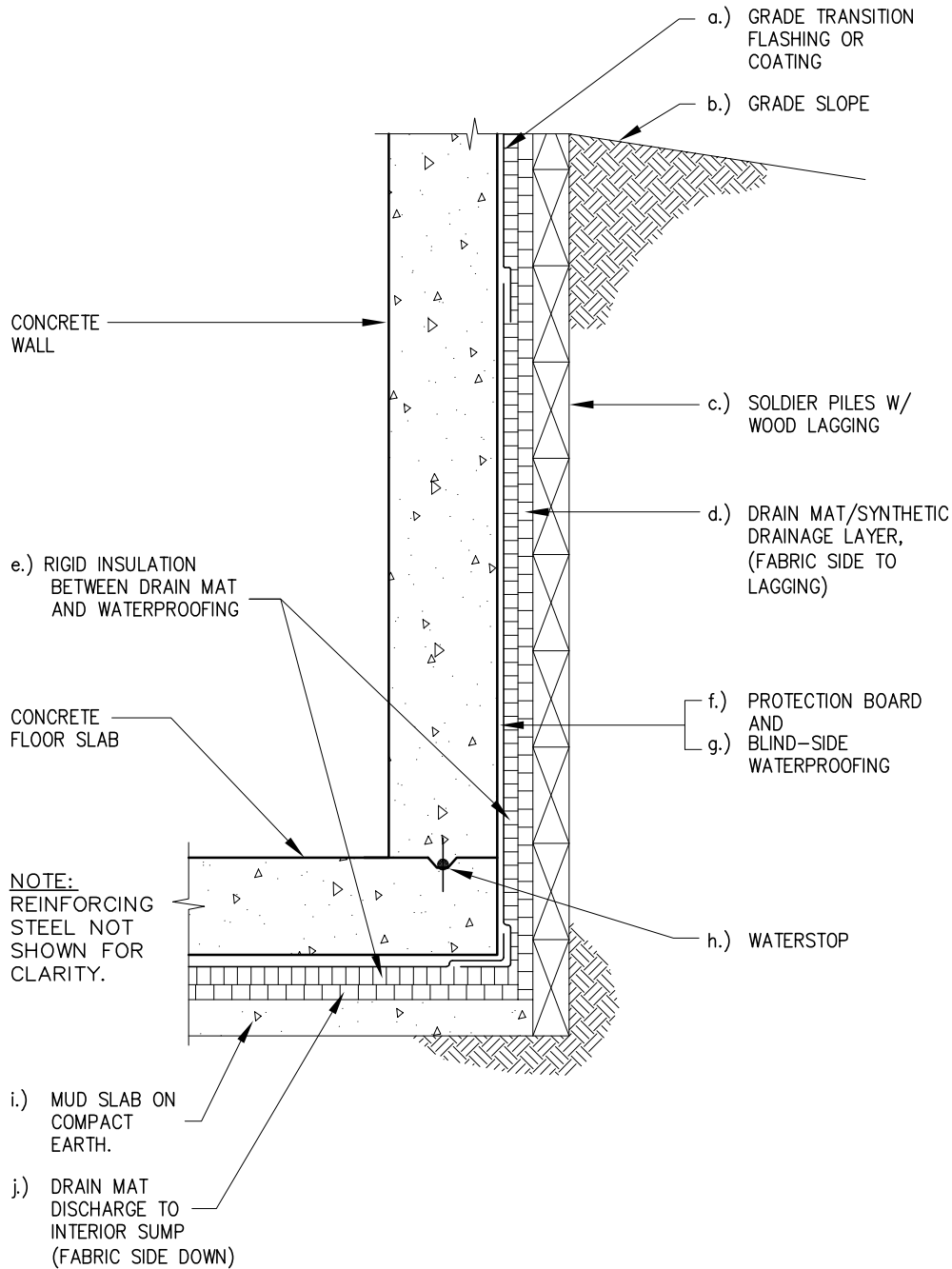

- a.) Provides continuity between upper building envelope weather shield & below grade waterproofing.
- b.) Directs building face sheet runoff & roof gutter overspill away from below grade waterproofing and drainage system.
- c.) Resists/contains earth load thrust forces.
- d/h) Intercepts soil moisture; prevents water head buildup.
- e.) Protects membrane and protection board from construction and thermal shock while in service, provides thermal resistance.
- f.) Protects membrane from construction damage.
- g.) Protects/prevents moisture penetration through wall and into building.
- h.) Prevents moisture migration through footer wall cold joint.
- i.) Provides stable work surface for floor slab waterproofing/ protection/ drainage/ isolation system installation
- j.) Removes collected water to interior sump discharge.

1.2.2

FOUNDATION WALL SYSTEM
BLIND-SIDE WATERPROOFING

CONCEPTUAL – NOT FOR CONSTRUCTION