

**Room Description:** Stress Testing, Treadmill (OPTM1)

**NSF:** 300

**OPTM1**

**Sheet Description:** Room/Equipment Isometric

**Scale:**

Sheet  
**1**

of  
**6**

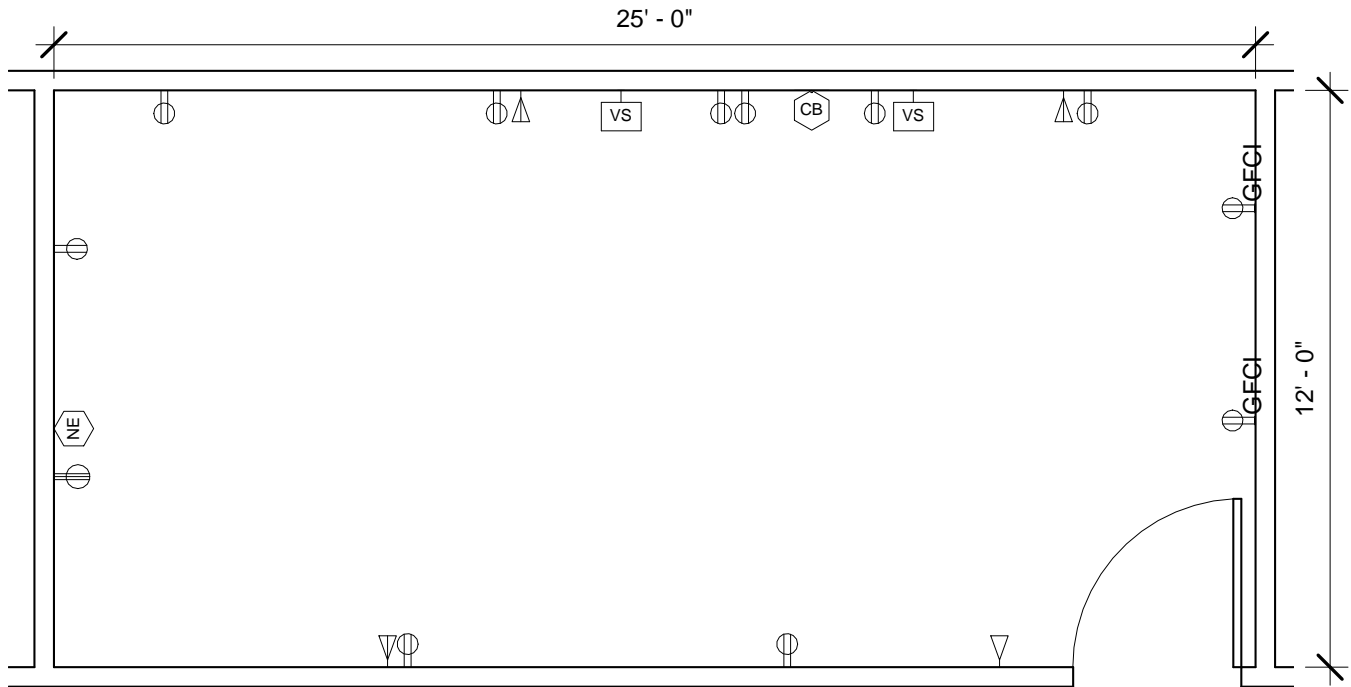

OPTM1 - FLOOR PLAN

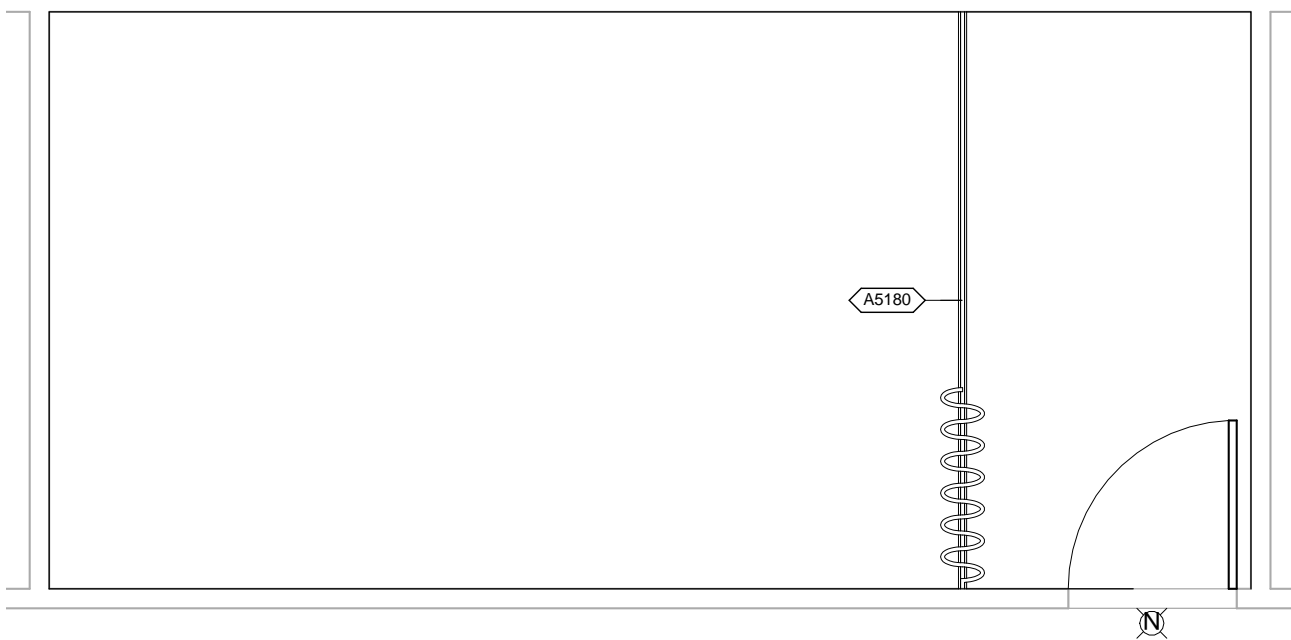

OPTM1 - CEILING MOUNTED EQUIPMENT PLAN

<b>Room Description:</b> Stress Testing, Treadmill (OPTM1)	<b>NSF:</b> 300	<b>OPTM1</b>	
<b>Sheet Description:</b> Floor & Ceiling Mounted Equipment Plan	<b>Scale:</b> 1/4" = 1'-0"	Sheet <b>2</b>	of <b>6</b>

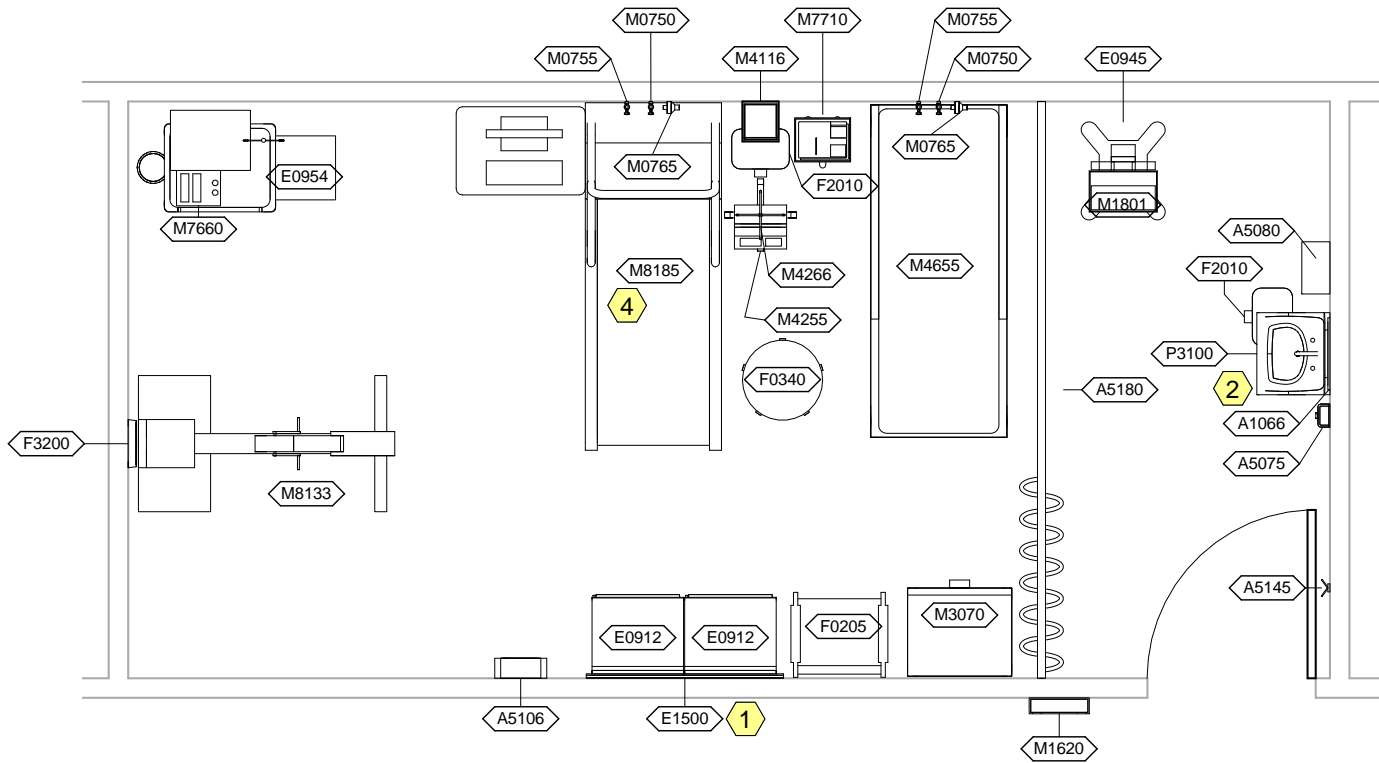

**OPTM1 - NOTES**

- 1 Length of JSN E1500, Wall Mounted Rail, to be determined by Manufacturer/Installer.
- 2 JSN P8710, Utility Center, shall be included in Navy projects only.
- 4 JSN M8185, Treadmill, may require a 220V outlet.

<b>Room Description:</b> Stress Testing, Treadmill (OPTM1)	<b>NSF:</b> 300	<h1>OPTM1</h1>	
<b>Sheet Description:</b> Equipment Plan	<b>Scale:</b> 1/4" = 1'-0"	Sheet <h2>3</h2>	of <h2>6</h2>

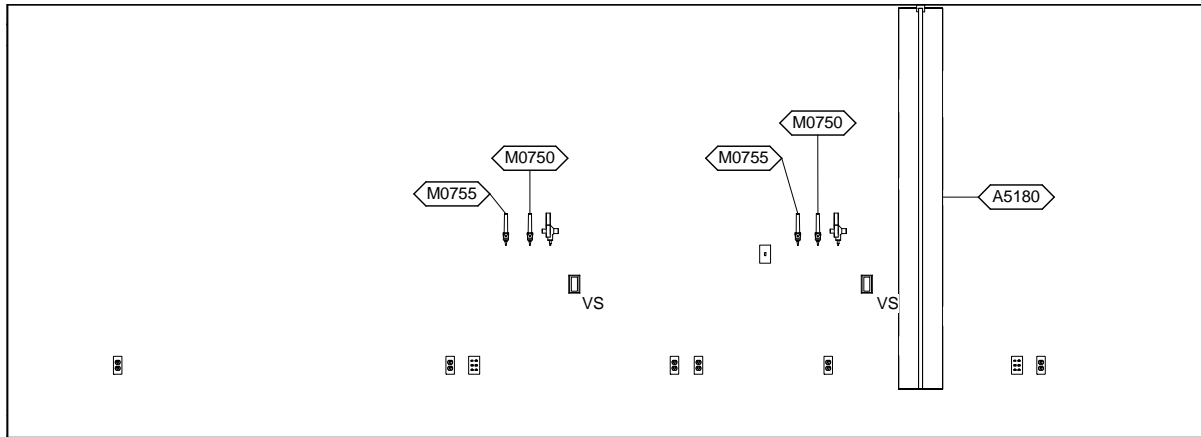

OPTM1 - NORTH ELEVATION

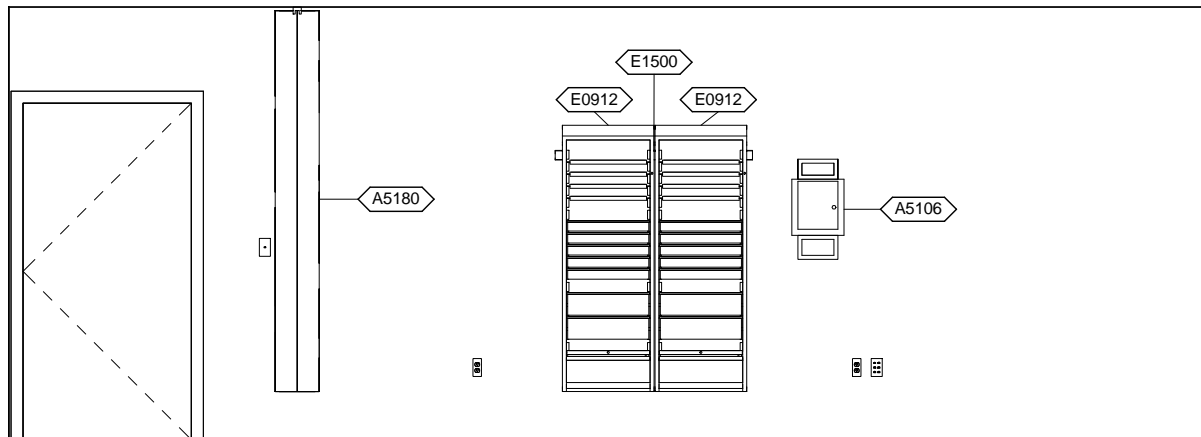

OPTM1 - SOUTH ELEVATION

<b>Room Description:</b> Stress Testing, Treadmill (OPTM1)	<b>NSF:</b> 300	<h1>OPTM1</h1>	
<b>Sheet Description:</b> Interior Room Elevations	<b>Scale:</b> 1/4" = 1'-0"	Sheet <h2>4</h2>	of <h2>6</h2>

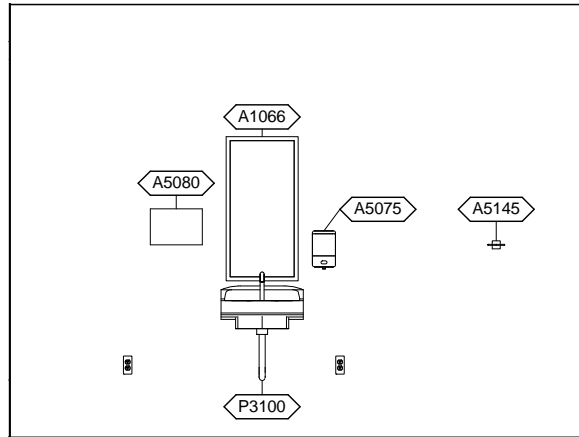

**OPTM1 - EAST ELEVATION**

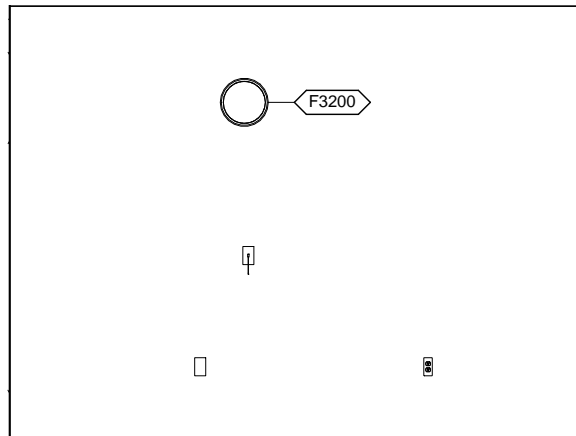

**OPTM1 - WEST ELEVATION**

<b>Room Description:</b> Stress Testing, Treadmill (OPTM1)	<b>NSF:</b> 300	<b>OPTM1</b>	
<b>Sheet Description:</b> Interior Room Elevations	<b>Scale:</b> 1/4" = 1'-0"	Sheet <b>5</b>	of <b>6</b>

OPTM1 - EQUIPMENT SCHEDULE

JSN	Nomenclature	Qty	LF	Logistics				Utilities					
				AR	NA	AF	VA	1	2	3	4	5	6
A1066	Mirror, Float Glass, With SS Frame	1		A	A	A	A	-	-	-	-	-	-
A5075	Dispenser, Soap, Disposable	1		C	C	C	C	-	-	-	-	-	-
A5080	Dispenser, Paper Towel, SS, Surface Mounted	1		A	A	A	A	-	-	-	-	-	-
A5106	Waste Disposal Unit, Sharps w/Glove Dispenser	1		C	A	C	C	-	-	-	-	-	-
A5145	Hook, Garment, Double, SS, Surface Mounted	1		A	A	A	A	-	-	-	-	-	-
A5180	Track, Cubicle, Surface Mounted, With Curtain	1	12'-0"	A	A	A	A	-	-	-	-	-	-
E0912	Locker, Supply, Med Surg, Wall Mtd	2		C	C	C	C	-	-	-	-	-	-
E0945	Mobile, Workstation	1		-	-	-	-	-	-	-	-	-	-
E0954	Cart, Emergency, Mobile, 66"H x 52"W x 22"D	1		C	C	C	C	-	-	-	-	-	-
E1500	Rail, MOD, W/MNTD, HX144XD	1		C	C	C	F	-	-	-	-	-	-
F0205	Chair, Side With Arms	1		C	C	C	C	-	-	-	-	-	-
F0340	Stool, Self Adjusting	1		C	C	C	C	-	-	-	-	-	-
F2010	Basket, Wastepaper, Step-On	2		C	C	C	C	-	-	-	-	-	-
F3200	Clock, Battery, 12" Diameter	1		C	C	C	C	-	-	-	-	-	-
M0750	Flowmeter, Air, Connect w/50 PSI Supply	2		C	C	C	C	-	-	K	-	-	-
M0755	Flowmeter, Oxygen, Low Flow	2		C	C	C	C	-	-	A	-	-	-
M0765	Regulator, Vacuum	2		C	C	C	C	-	-	B	-	-	-
M1620	Holder, Chart, Patient, Wall or Door Mounted	1		C	C	C	C	-	-	-	-	-	-
M1801	Computer, Microprocessing, w/Flat Panel Monitor	1		C	C	C	C	-	A	-	-	-	-
M3070	Hamper, Linen, Mobile, w/Lid	1		C	C	C	C	-	-	-	-	-	-
M4116	Monitor, Vital Signs	1		C	C	C	C	-	A	-	-	-	-
M4255	Stand, IV, Adjustable	1		C	C	C	C	-	-	-	-	-	-
M4266	Pump, Volumetric, Infusion, Multiple Line	1		C	C	C	C	-	A	-	-	-	-
M4655	Stretcher, Mobile, CRS, 9 Position	1		C	C	C	C	-	-	-	-	-	-
M7660	Defibrillator/Monitor/Recorder, Portable	1		C	C	C	C	-	A	-	-	-	-
M7710	Electrocardiograph, 12 Lead, Portable	1		C	C	C	C	-	A	-	-	-	-
M8133	Ergometer, Upper Body	1		C	C	C	C	-	A	-	-	-	-
M8185	System, Stress Exercise, w/Treadmill	1		C	C	C	C	-	D	-	-	-	-
P3100	Lavatory, Vitreous China, Slab Type	1		A	A	A	A	D	-	-	-	-	-

OPTM1 - DATA/TELEPHONE EQUIPMENT

JSN	Nomenclature	Qty	Logistics			
			AR	NA	AF	VA
A1010	Telecommunication Outlet	3	A	A	A	A
A1014	Telephone, Wall Mounted, 1 Line, with Speaker	1	A	A	A	A

<b>Room Description:</b> Stress Testing, Treadmill (OPTM1)	<b>NSF:</b> 300	<b>OPTM1</b>	
<b>Sheet Description:</b> Equipment Schedule	<b>Scale:</b>	Sheet <b>6</b>	of <b>6</b>