

**OPTM1 - INTERIOR DESIGN**

Floor Finish		Wall Finish		Ceiling Finish		Room Height	Room Noise		
Preferred	Alternate	Preferred	Alternate	Preferred	Alternate	ft - in	Min NC	Max NC	SC
VT	-	GPT	-	AT1	-	9' - 0"	35	40	50

**OPTM1 - DOOR SCHEDULE**

Mark	Type	Count	Height	Width	Notes
			ft - in	ft - in	
A	Single-Flush	1	7' - 0"	4' - 0"	

**Room Description:** Stress Testing, Treadmill

**NSF:** 300

**OPTM1**

**Plate Description:** Room/Equipment Isometric

**Scale:**

Sheet

**1**

of

**6**

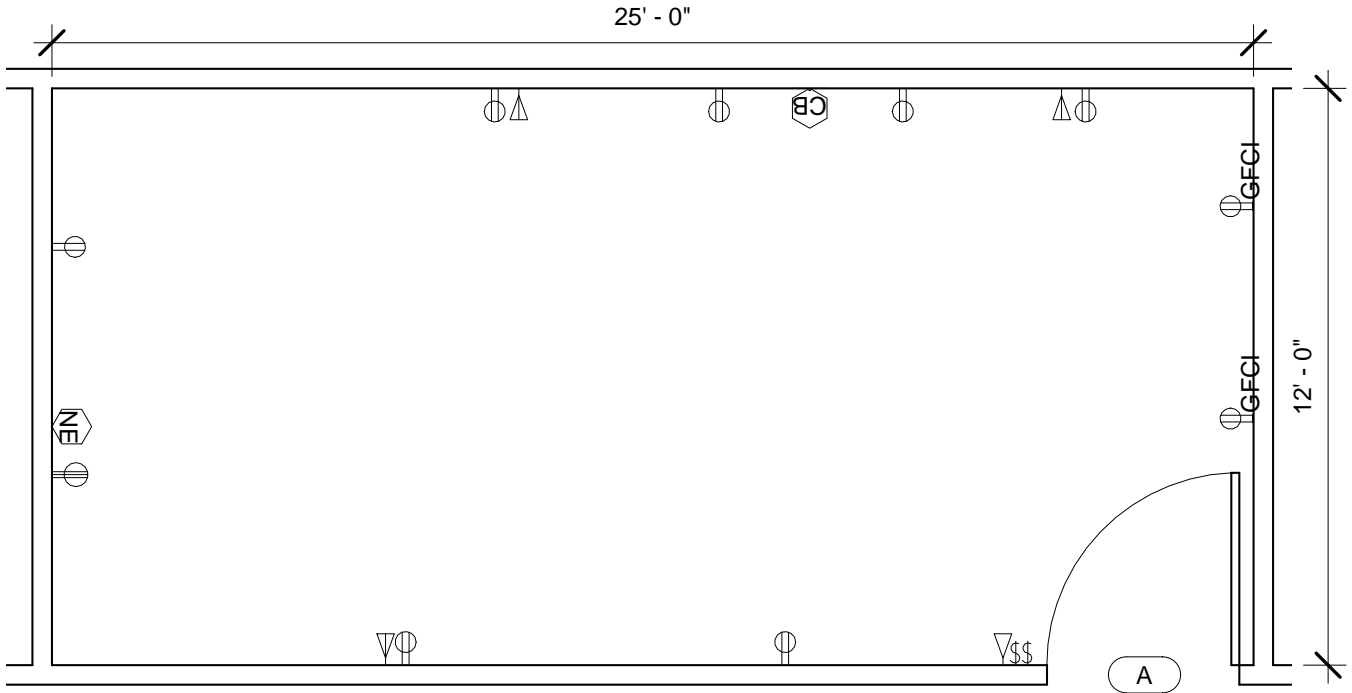

OPTM1 - FLOOR PLAN

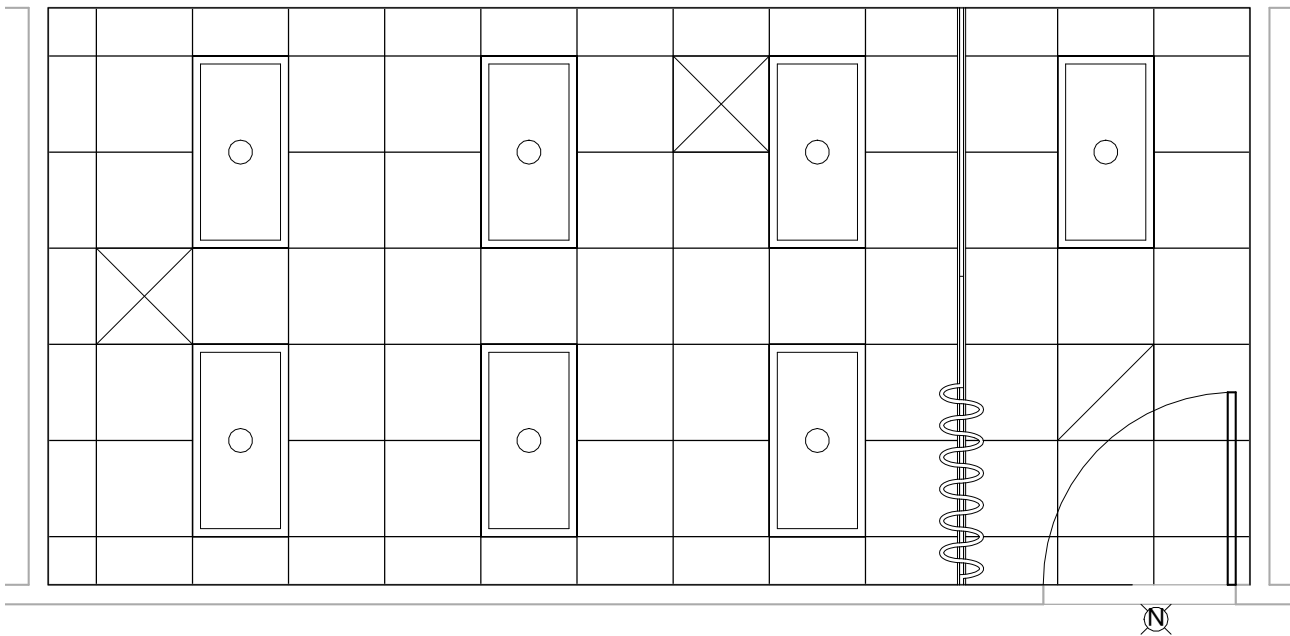

OPTM1 - CEILING PLAN

<b>Room Description:</b> Stress Testing, Treadmill	<b>NSF:</b> 300	<b>OPTM1</b>	
<b>Plate Description:</b> Floor Plan & Ceiling Plan	<b>Scale:</b> 1/4" = 1'-0"	Sheet <b>2</b>	of <b>6</b>

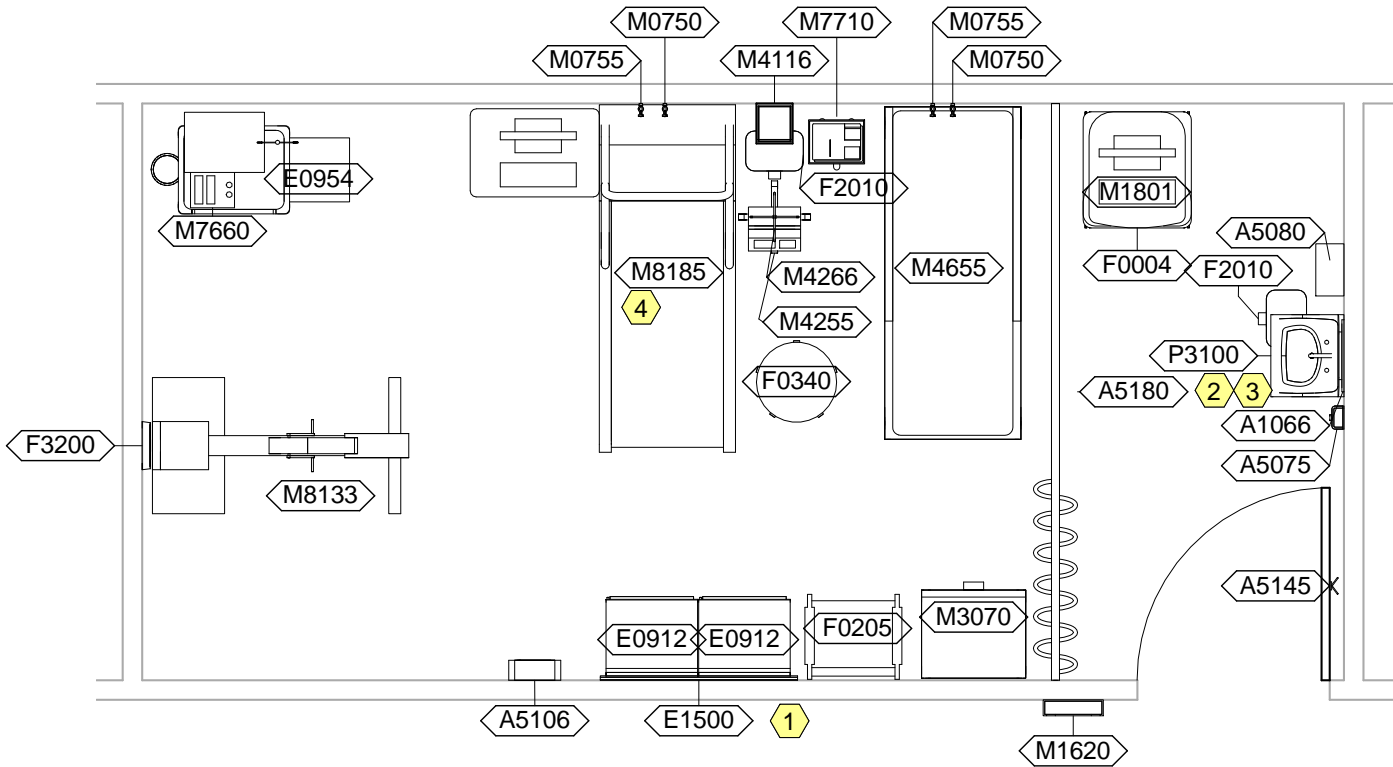

**OPTM1 - NOTES**

- 1 Length of JSN E1500, Wall Mounted Rail, to be determined by Manufacturer/Installer.
- 2 JSN P3200, Lavatory Electronic, may be used instead of JSN P3100, Lavatory. For the JSN P3200, Lavatory Electronic, provide either battery power or hard wired connection.
- 3 JSN P8710, Utility Center, shall be included in Navy projects only.
- 4 JSN M8185, Treadmill, may require a 220V outlet.

<b>Room Description:</b> Stress Testing, Treadmill	<b>NSF:</b> 300	<b>OPTM1</b>	
<b>Plate Description:</b> Equipment Plan	<b>Scale:</b> 1/4" = 1'-0"	Sheet <b>3</b>	of <b>6</b>

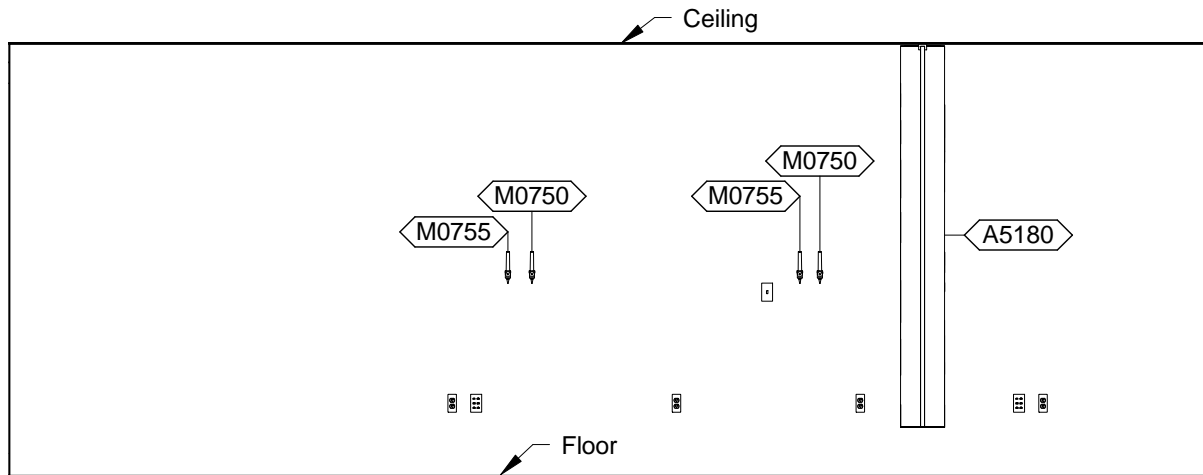

OPTM1 - PLAN NORTH

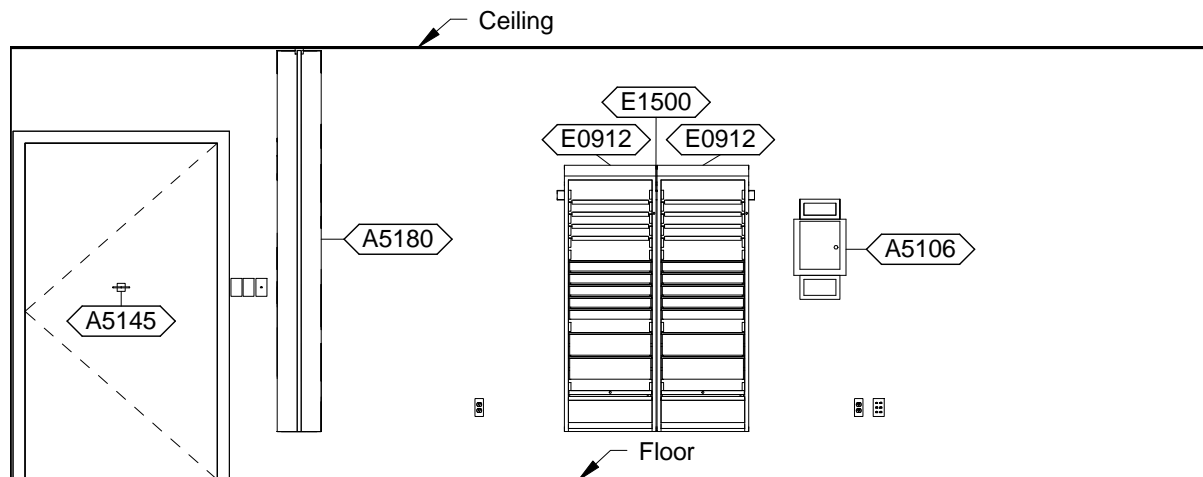

OPTM1 - PLAN SOUTH

<b>Room Description:</b> Stress Testing, Treadmill	<b>NSF:</b> 300	<b>OPTM1</b>	
<b>Plate Description:</b> Interior Room Elevations	<b>Scale:</b> 1/4" = 1'-0"	Sheet <b>4</b>	of <b>6</b>

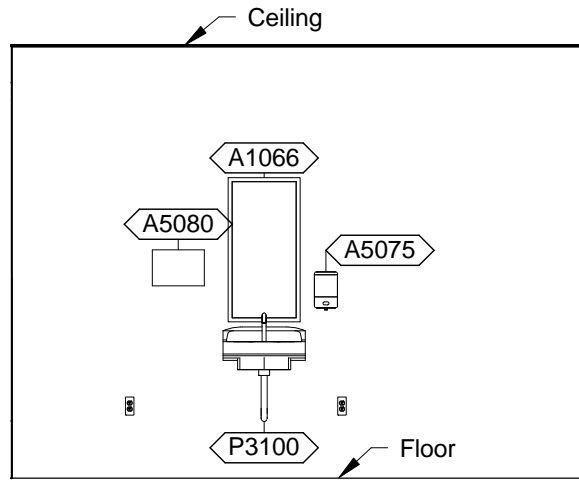

OPTM1 - PLAN EAST

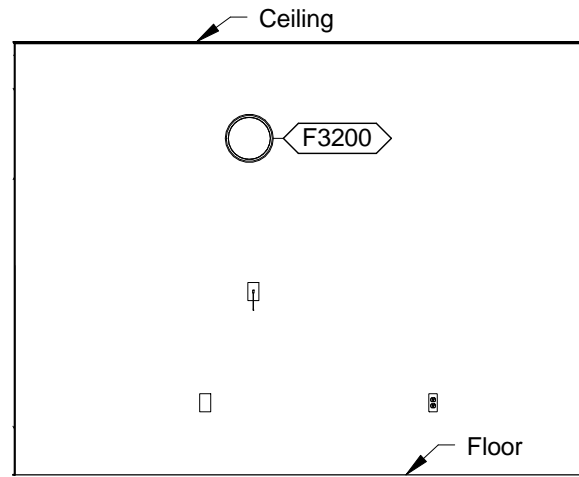

OPTM1 - PLAN WEST

<b>Room Description:</b> Stress Testing, Treadmill	<b>NSF:</b> 300	<b>OPTM1</b>	
<b>Plate Description:</b> Interior Room Elevations	<b>Scale:</b> 1/4" = 1'-0"	Sheet <b>5</b>	of <b>6</b>

OPTM1 - EQUIPMENT SCHEDULE

JSN	Nomenclature	Qty	Logistics				Utilities					
			AR	NA	AF	VA	1	2	3	4	5	6
A1066	Mirror, Float Glass, With SS Frame	2	A	A	A	A	-	-	-	-	-	-
A5075	Dispenser, Soap, Disposable	1	C	C	C	C	-	-	-	-	-	-
A5080	Dispenser, Paper Towel, SS, Surface Mounted	1	A	A	A	A	-	-	-	-	-	-
A5106	Waste Disposal Unit, Sharps w/Glove Dispenser	1	C	A	C	C	-	-	-	-	-	-
A5145	Hook, Garment, Double, SS, Surface Mounted	1	A	A	A	A	-	-	-	-	-	-
A5180	Track, Cubicle, Surface Mounted, With Curtain	1	A	A	A	A	-	-	-	-	-	-
E0912	Locker, Supply, Med Surg, Wall Mtd	2	C	C	C	C	-	-	-	-	-	-
E0954	Cart, Emergency, Mobile, 66"H x 52"W x 22"D	1	C	C	C	C	-	-	-	-	-	-
E1500	Rail, MOD, W/MNTD, HX144XD	1	C	C	C	F	-	-	-	-	-	-
F0004	Mobile, Workstation	1	C	C	C	C	-	-	-	-	-	-
F0205	Chair, Side With Arms	1	C	C	C	C	-	-	-	-	-	-
F0340	Stool, Self Adjusting	1	C	C	C	C	-	-	-	-	-	-
F2010	Basket, Wastepaper, Step-On	2	C	C	C	C	-	-	-	-	-	-
F3200	Clock, Battery, 12" Diameter	1	C	C	C	C	-	-	-	-	-	-
M0750	Flowmeter, Air, Connect w/50 PSI Supply	2	C	C	C	C	-	-	K	-	-	-
M0755	Flowmeter, Oxygen, Low Flow	2	C	C	C	C	-	-	A	-	-	-
M1620	Holder, Chart, Patient, Wall or Door Mounted	1	C	C	C	C	-	-	-	-	-	-
M1801	Computer, Microprocessing, w/Flat Panel Monitor	1	C	C	C	C	-	A	-	-	-	-
M3070	Hamper, Linen, Mobile, w/Lid	1	C	C	C	C	-	-	-	-	-	-
M4116	Monitor, Vital Signs	1	C	C	C	C	-	A	-	-	-	-
M4255	Stand, IV, Adjustable	1	C	C	C	C	-	-	-	-	-	-
M4266	Pump, Volumetric, Infusion, Multiple Line	1	C	C	C	C	-	A	-	-	-	-
M4655	Stretcher, Mobile, CRS, 9 Position	1	C	C	C	C	-	-	-	-	-	-
M7660	Defibrillator/Monitor/Recorder, Portable	1	C	C	C	C	-	A	-	-	-	-
M7710	Electrocardiograph, 12 Lead, Portable	1	C	C	C	C	-	A	-	-	-	-
M8133	Ergometer, Upper Body	1	C	C	C	C	-	A	-	-	-	-
M8185	System, Stress Exercise, w/Treadmill	1	C	C	C	C	-	D	-	-	-	-
P3100	Lavatory, Vitreous China, Slab Type	1	A	A	A	A	D	-	-	-	-	-

OPTM1 - DATA/TELEPHONE EQUIPMENT

JSN	Nomenclature	Qty	Logistics			
			AR	NA	AF	VA
A1010	Telecommunication Outlet	3	A	A	A	A
A1014	Telephone, Wall Mounted, 1 Line, with Speaker	1	A	A	A	A

<b>Room Description:</b> Stress Testing, Treadmill	<b>NSF:</b> 300	<b>OPTM1</b>	
<b>Plate Description:</b> Equipment Schedule	<b>Scale:</b>	Sheet <b>6</b>	of <b>6</b>