

**Room Description:** Dental Instrument, Sterilization, Medium (DN5C5)

**NSF:** 360

**DN5C5**

**Sheet Description:** Room/Equipment Isometric

**Scale:**

Sheet  
**1**

of  
**6**

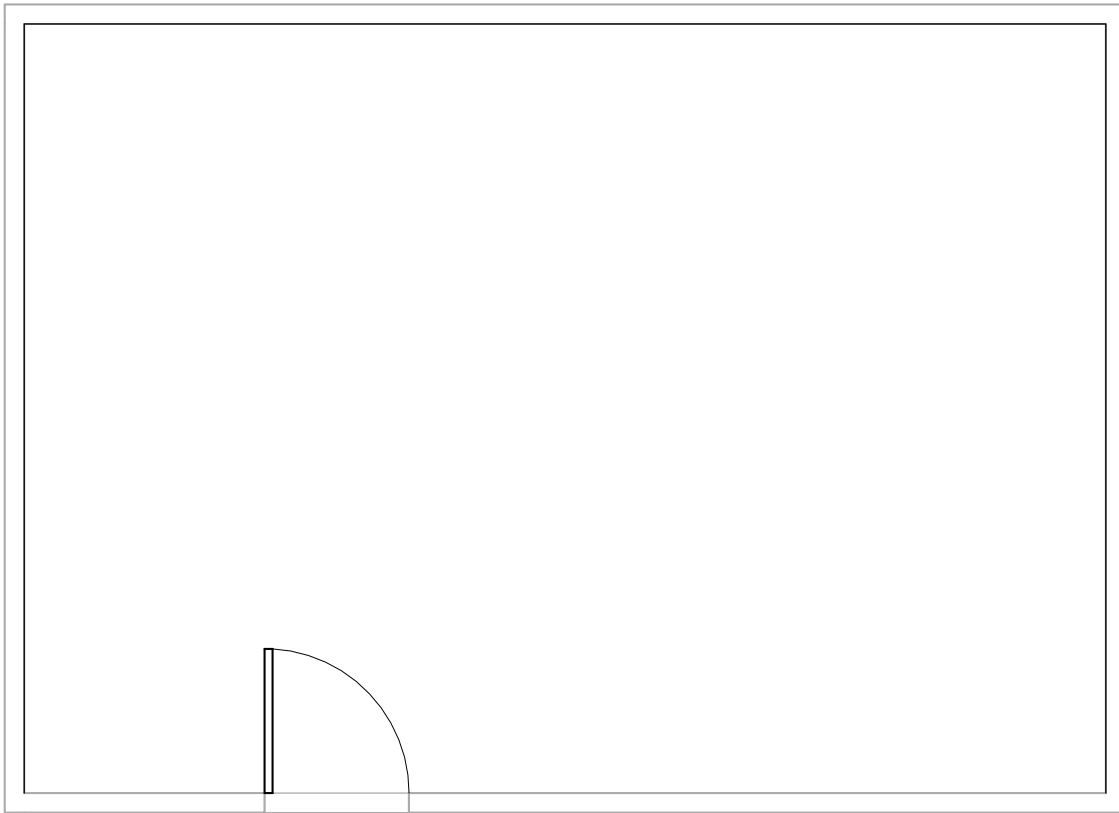

**DN5C5 - CEILING MOUNTED EQUIPMENT PLAN**

<b>Room Description:</b> Dental Instrument, Sterilization, Medium (DN5C5)	<b>NSF:</b> 360	<b>DN5C5</b>	
<b>Sheet Description:</b> Ceiling Mounted Equipment Plan	<b>Scale:</b> 1/4" = 1'-0"	Sheet <b>2</b>	of <b>6</b>

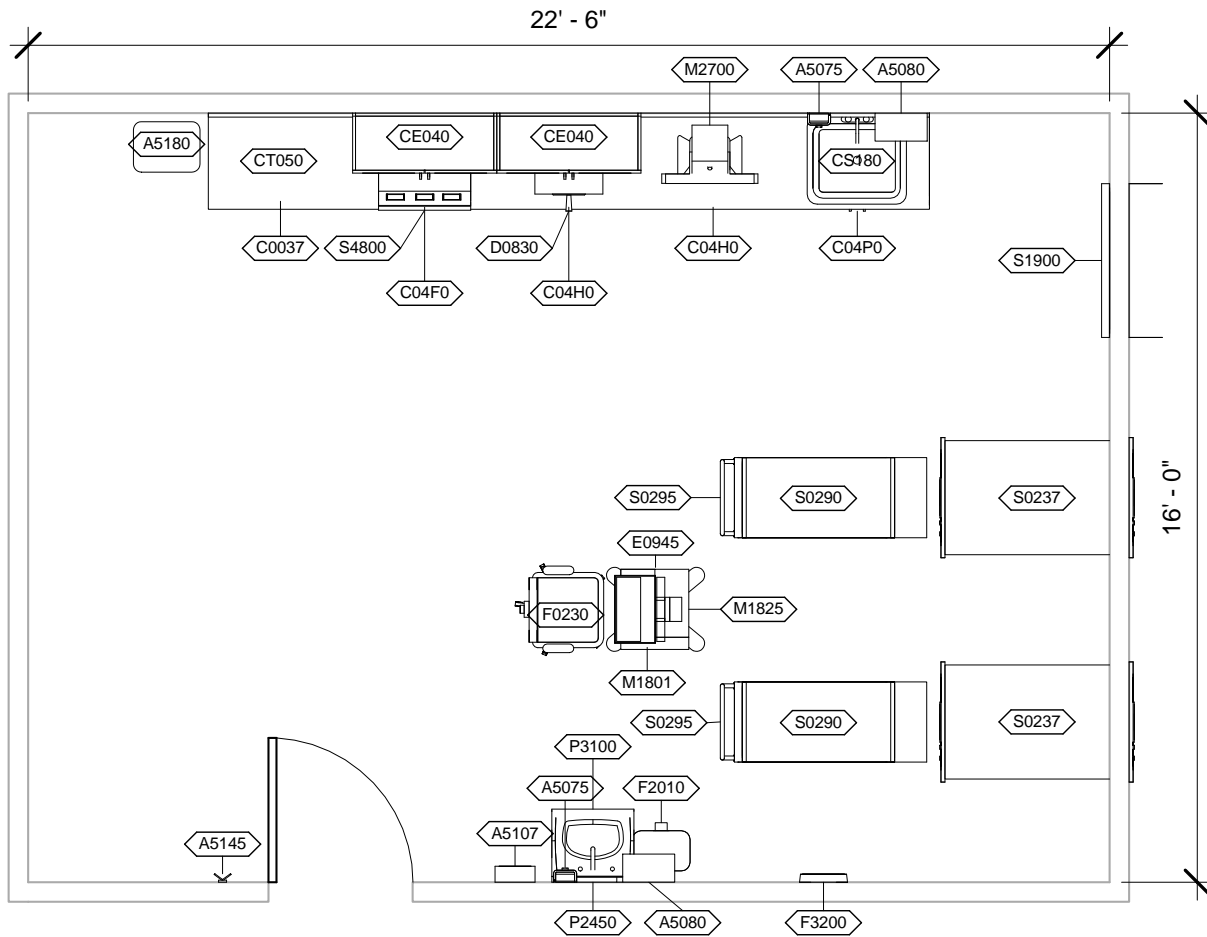

<b>Room Description:</b> Dental Instrument, Sterilization, Medium (DN5C5)	<b>NSF:</b> 360	<b>DN5C5</b>	
<b>Sheet Description:</b> Equipment Plan	<b>Scale:</b> 1/4" = 1'-0"	Sheet <b>3</b>	of <b>6</b>

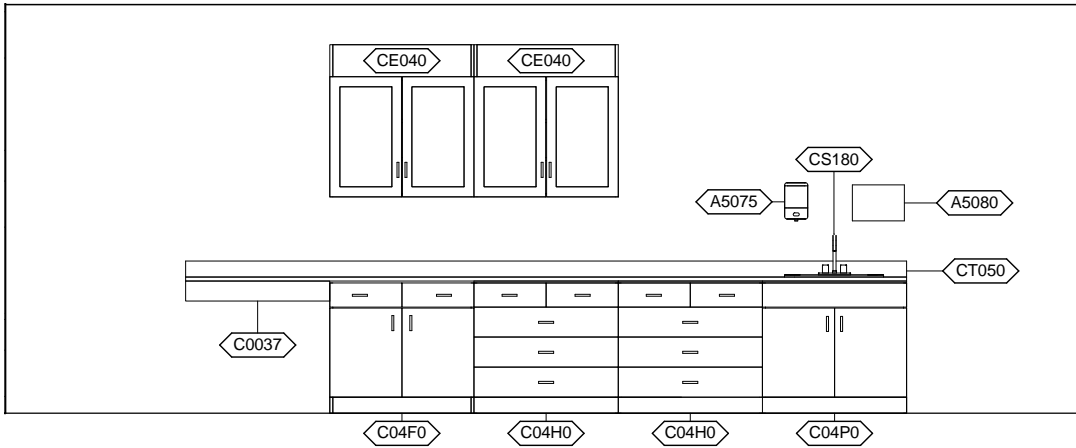

DNSC5 - NORTH ELEVATION

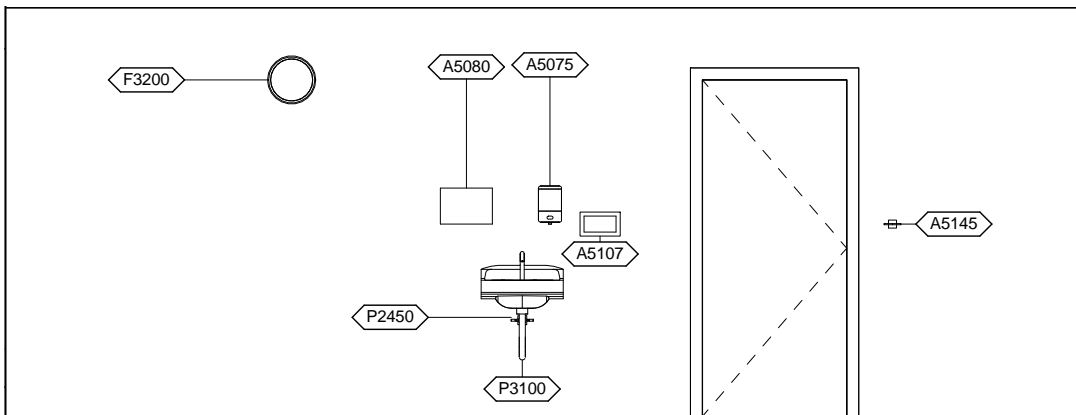

DNSC5 - SOUTH ELEVATION

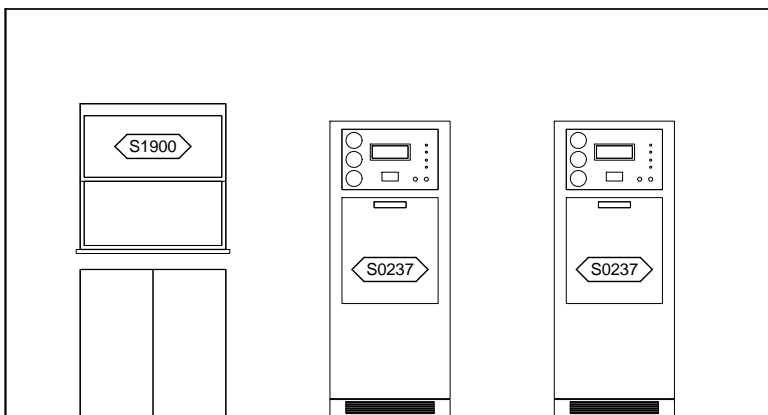

DNSC5 - EAST ELEVATION



DNSC5 - WEST ELEVATION

<b>Room Description:</b> Dental Instrument, Sterilization, Medium (DNSC5)	<b>NSF:</b> 360	<b>DNSC5</b>	
<b>Sheet Description:</b> Interior Room Elevations	<b>Scale:</b> 1/4" = 1'-0"	Sheet <b>4</b>	of <b>6</b>

DNSC5 - EQUIPMENT SCHEDULE

JSN	Nomenclature	Qty	LF	Logistics				Utilities						
				AR	NA	AF	VA	1	2	3	4	5	6	
A5075	Dispenser, Soap, Disposable	2		C	C	C	C	-	-	-	-	-	-	-
A5080	Dispenser, Paper Towel, SS, Surface Mounted	2		A	A	A	A	-	-	-	-	-	-	-
A5107	Dispenser, Glove, Surgical/Examination, Wall Mntd	1		C	C	-	-	-	-	-	-	-	-	-
A5145	Hook, Garment, Double, SS, Surface Mounted	1		A	A	A	A	-	-	-	-	-	-	-
A5180	Waste Disposal Unit, Sharps	1		C	C	-	-	-	-	-	-	-	-	-
C04F0	Cabinet, U/C/B, 1 Shelf, 2 Half DR, 2 DO, 36x36x22	1		A	A	A	A	-	-	-	-	-	-	-
C04H0	Cabinet, U/C/B, 2 Half Drawer, 3 Drawer, 36x36x22	2		A	A	-	-							
C04P0	Cabinet, Sink, U/C/B, 2 Door, 36x36x22	1		A	A	-	-							
C0037	Rail, Apron, 4x36x1	2		A	A	-	-							
CE040	Cabinet, W/H, 2 SH, 2 GDO, Sloping Top, 38x36x13	2		A	A	-	-							
CS180	Sink, SS, Single Compartment, 12x22x16 ID	1		A	A	-	-	D	-	-	-	-	-	-
CT050	Countertop, Stainless Steel	1	13' - 6"	A	A	-	-							
D0830	Sterilizer, Rapid Dry Heat	1		C	C	C	C	-	A	-	-	-	-	-
E0945	Cart, Computer, Mobile	1		C	C	-	-							
F0230	Chair, Drafting, Rotary	1		C	C	-	-							
F2010	Basket, Wastepaper, Step-On	1		C	C	C	C	-	-	-	-	-	-	-
F3200	Clock, Battery, 12" Diameter	1		C	C	C	C	-	-	-	-	-	-	-
M1801	Computer, Microprocessing, w/Flat Panel Monitor	1		C	C	-	-		A					
M1825	Printer, Computer	1		C	C	-	-		A					
M2700	Sealer, Heat, Plastic Bag, w/Motor, Portable	1		C	C	-	-		A					
P2450	Valve, Mixing, Thermostatic	1		A	A	-	-	A						
P3100	Lavatory, Vitreous China, Slab Type	1		A	A	A	A	D	-	-	-	-	-	-
S0237	Sterilizer,ELEC,VAC,2DO,RCSD 1WLL, 20x20x38 Cham	2		A	A	A	A	D	F	-	-	-	-	-
S0290	Rack, 2SH, 20x20x38 CHMBR	4		A	A	-	-							
S0295	Loading Car & Transfer Carriage, 20x20x38 Chamber	2		A	A	-	-							
S1900	Pass-through Window	1		A	A	-	-	-	-	-	-	-	-	-
S4800	Sterilizer, SURG INSTRU & Dressing, 10" DIA CHMBR	1		C	C	-	-		B					

<b>Room Description:</b> Dental Instrument, Sterilization, Medium (DNSC5)	<b>NSF:</b> 360	<b>DNSC5</b>	
<b>Sheet Description:</b> Equipment Schedule	<b>Scale:</b>	Sheet <b>5</b>	of <b>6</b>

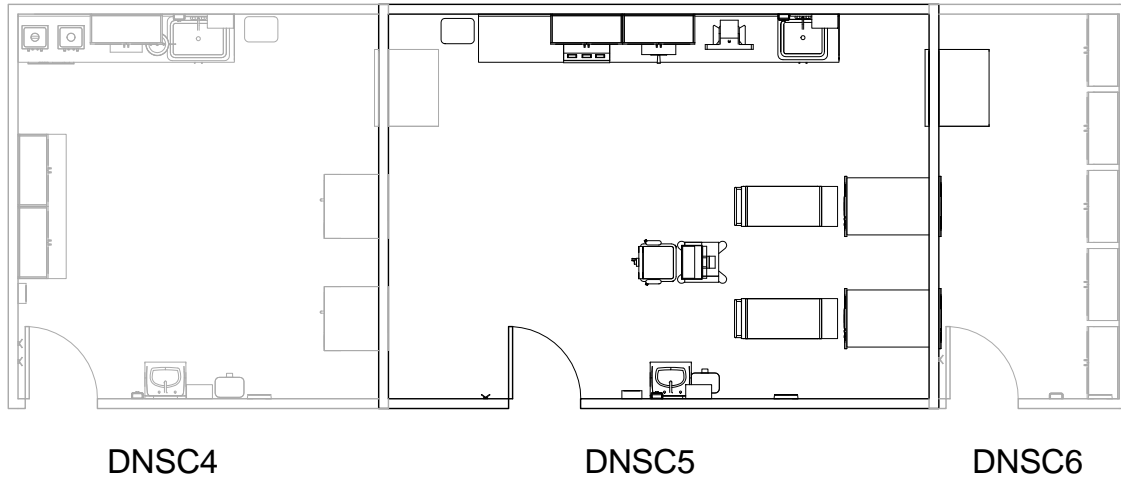

**Room Description:** Dental Instrument, Sterilization, Medium (DNSC5)

**NSF:** 360

**DNSC5**

**Sheet Description:** Flow Diagram

**Scale:** 1/8" = 1'-0"

Sheet  
**6**

of  
**6**